

PIPE ETAGERE HANGFOLD RETROFIT KIT

Item # PSETGHR(F)

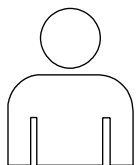
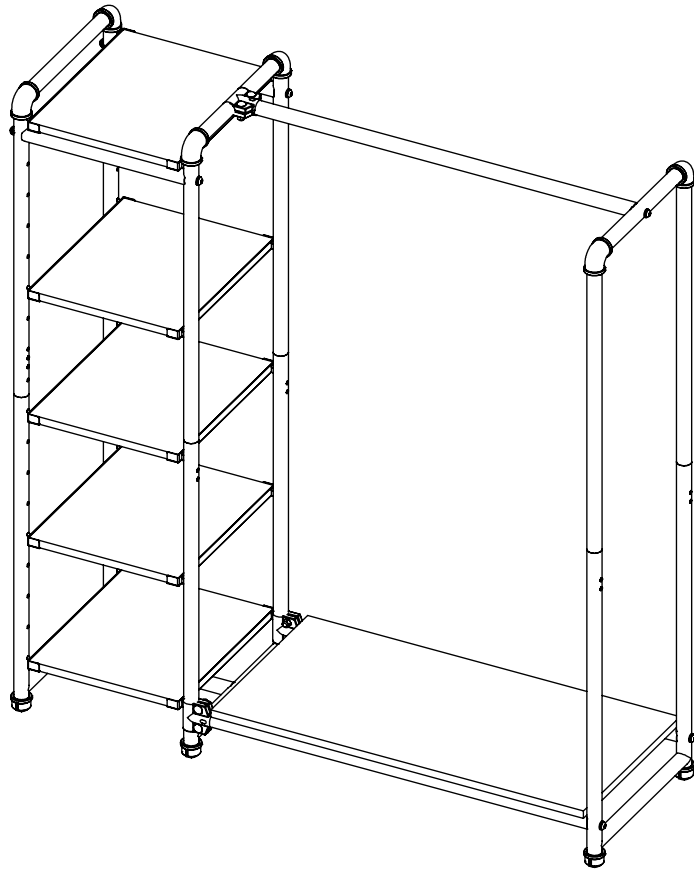

**2 PEOPLE
REQUIRED
FOR
ASSEMBLY**

INCLUDED HARDWARE

8X

1/4"-20 x 1" LONG
SET SCREW



3X

3/8"-16 x 2.5" LONG
SOCKET BUTTON
HEAD CAP SCREW

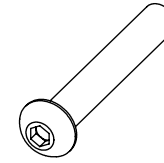

6X

3/8-16 X 1.5" LONG
CARRIAGE BOLT

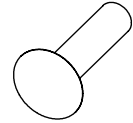

4X

1/4"-20 x 0.5" LONG
SOCKET HEAD CAP SCREW



3X

3/8" LOCK WASHER



6X

3/8" WASHER NUT
WITH TEETH



3X

3/8" FLAT WASHER



TOOLS REQUIRED

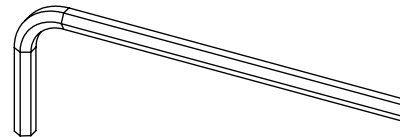

LARGE ALLEN KEY



SMALL ALLEN KEY

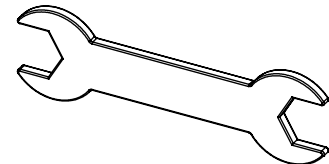

WRENCH

1

MOUNT LOWER UPRIGHT TO UPPER UPRIGHT.

ENSURE THAT BOTH LEVELERS ARE PROPERLY SCREWED INTO THE BOTTOM

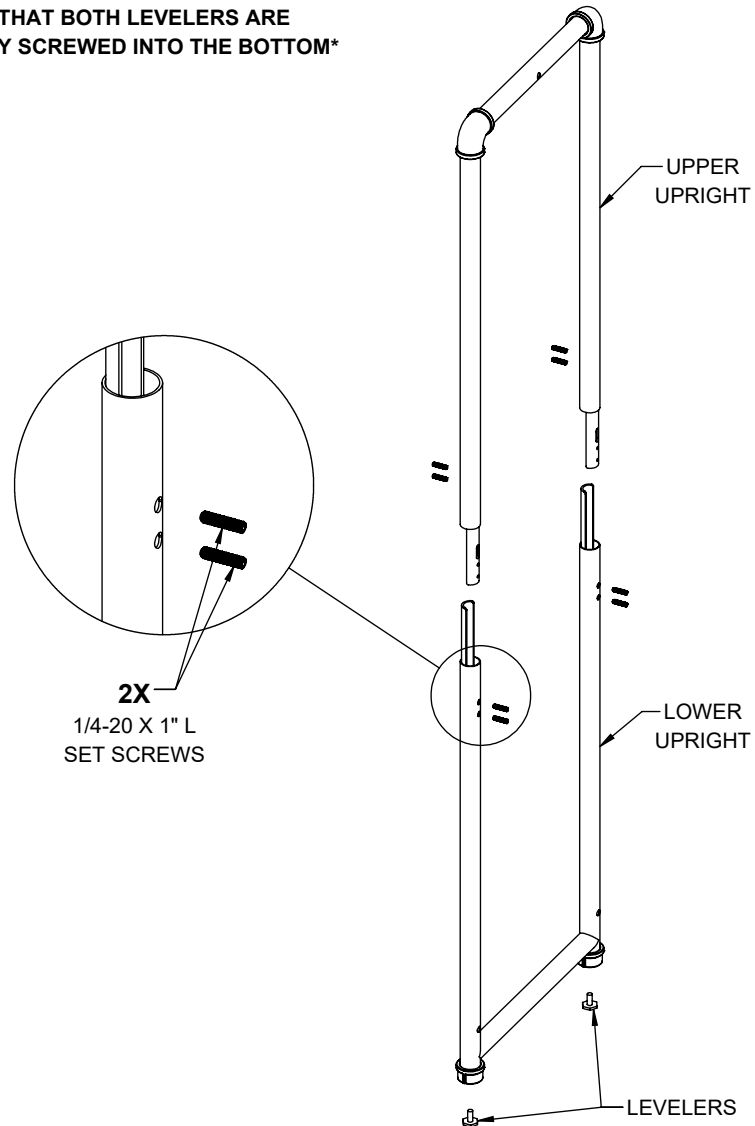

2

REST THE WELDED CLAMP SIDE OF THE CROSSBAR ON TO THE TOP OF THE ETAGERE, AND CONNECT THE END FRAME TO THE OTHER SIDE OF THE CROSSBAR.

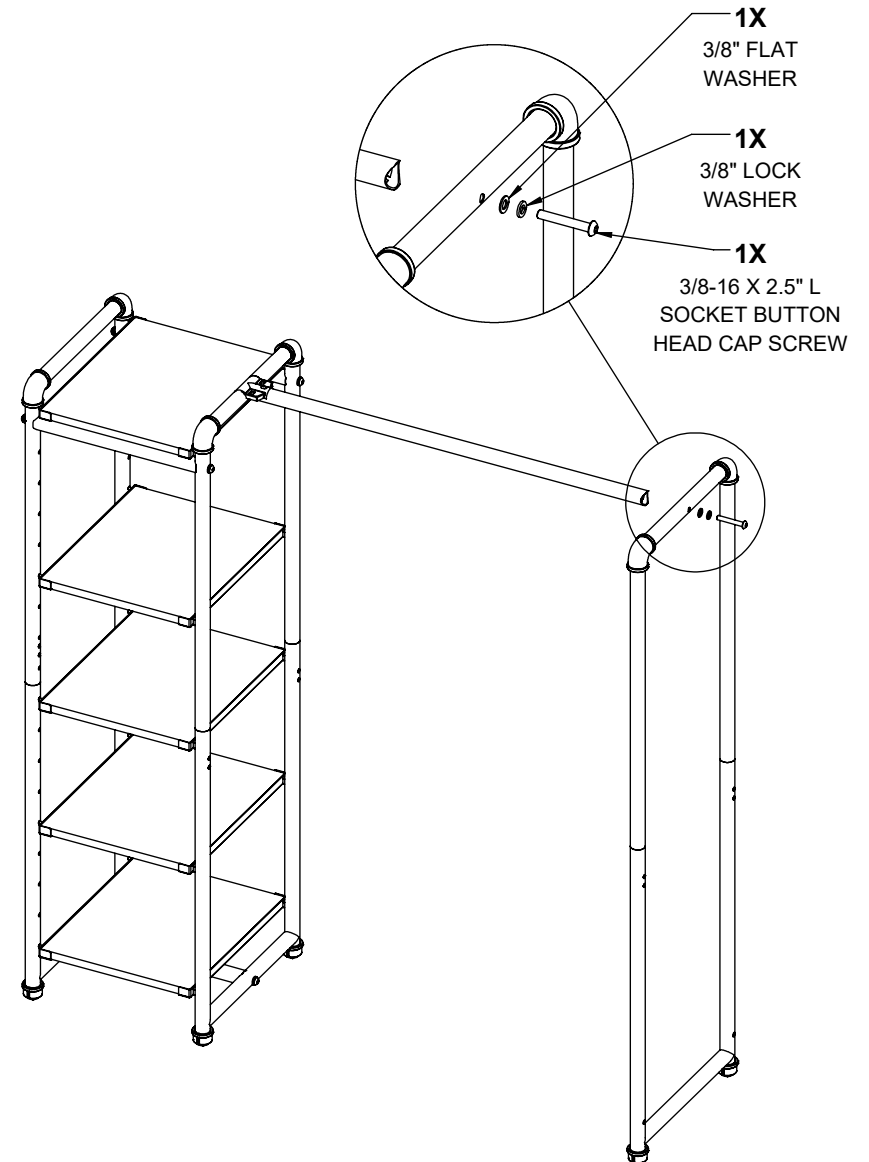

3

FASTEN THE CLAMP IN PLACE.

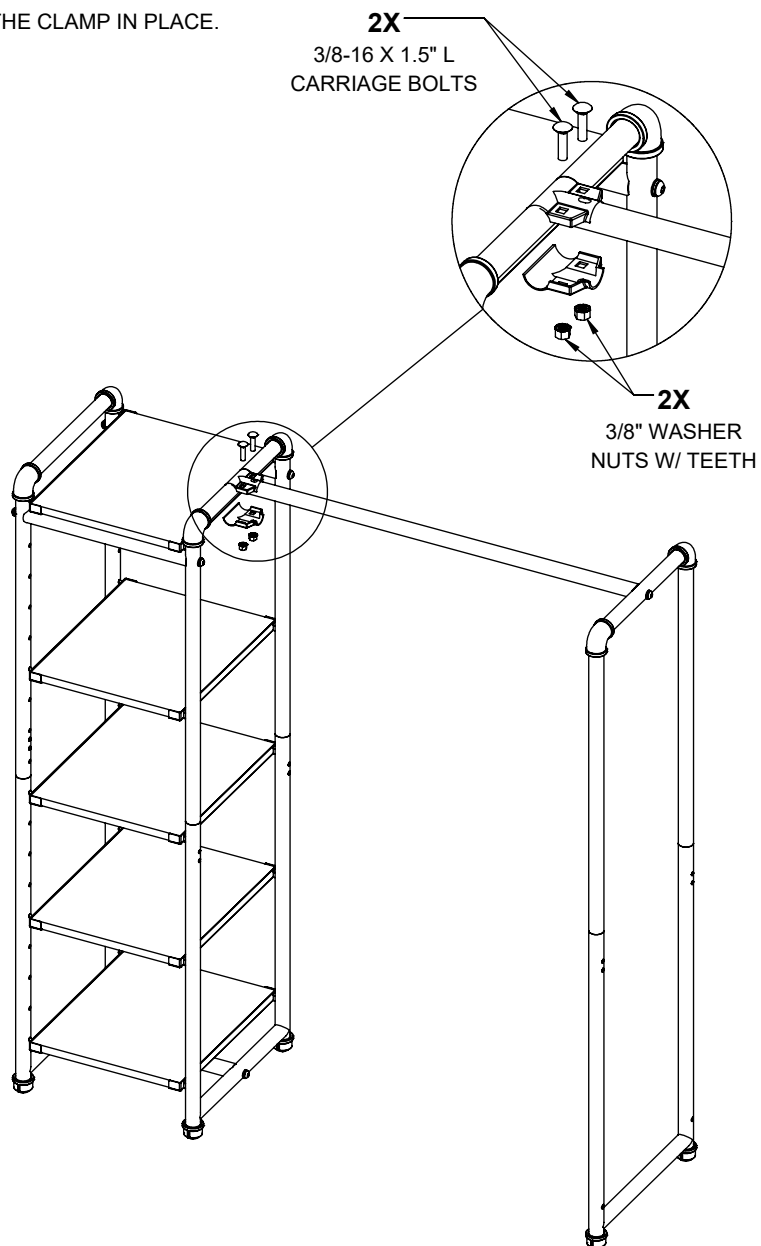

4A

FASTEN THE LOWER FRONT CROSSBAR CLAMP TO THE ETAGERE.

4B

THEN, CONNECT THE CROSSBAR TO THE END FRAME.

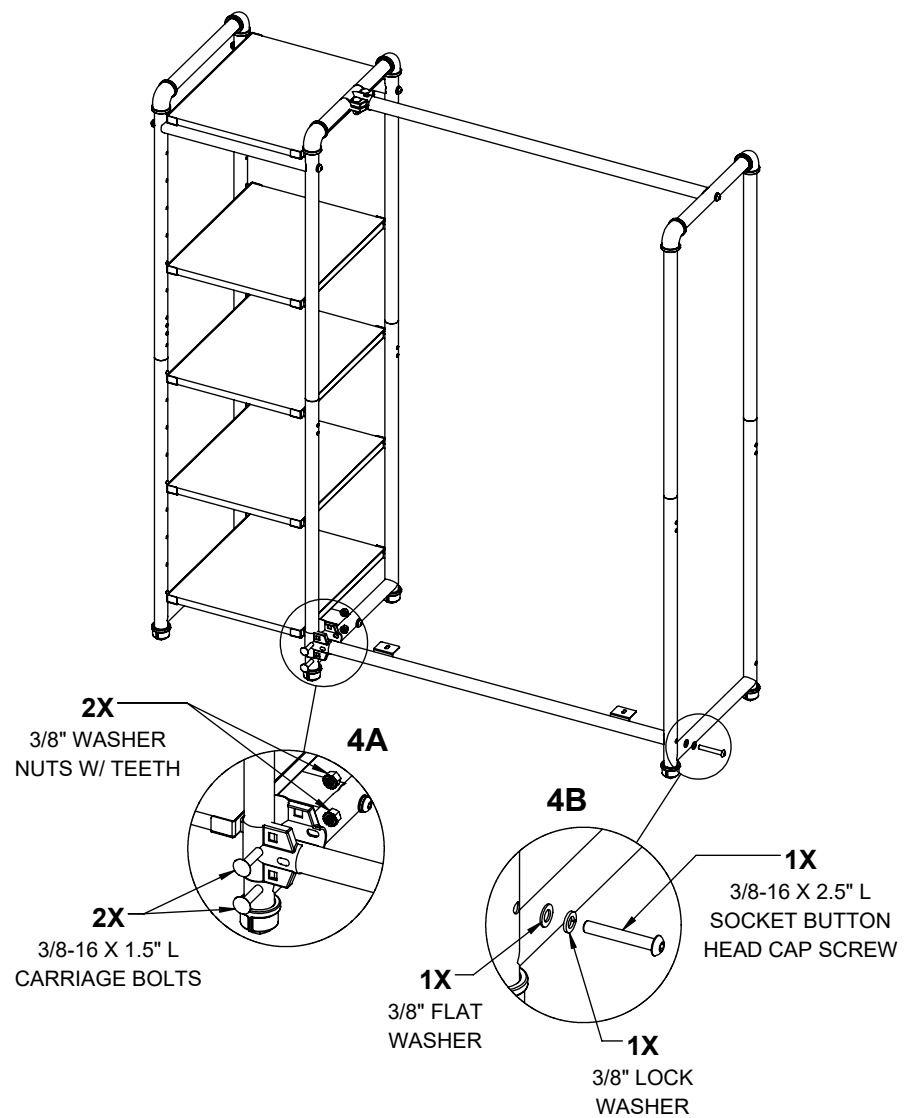

5

REPEAT THE PREVIOUS STEP FOR THE OTHER CROSSBAR.

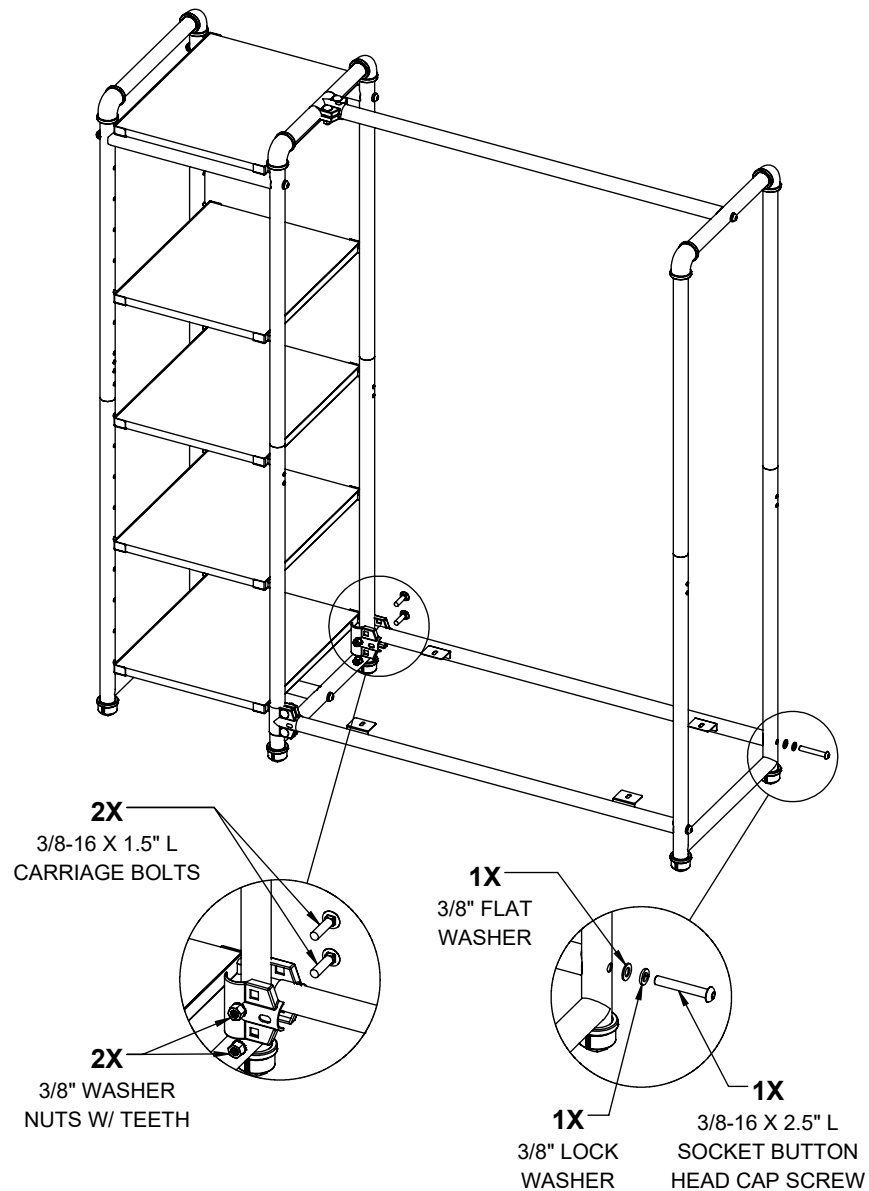

6

MOUNT THE SHELF PANEL TO THE LOWER CROSSBARS.

ASSEMBLY IS NOW COMPLETE

